

## Operating Instructions

These instructions should be read carefully and retained for future reference. Note also the information given on the appliance.

### **Storage heaters**

#### **XM(X) manual**

Models: XM(X)706N

XM(X)712N

XM(X)718N

XM(X)724N

#### **XMS(N) automatic**

XMS712N

XMS718N

XMS724N

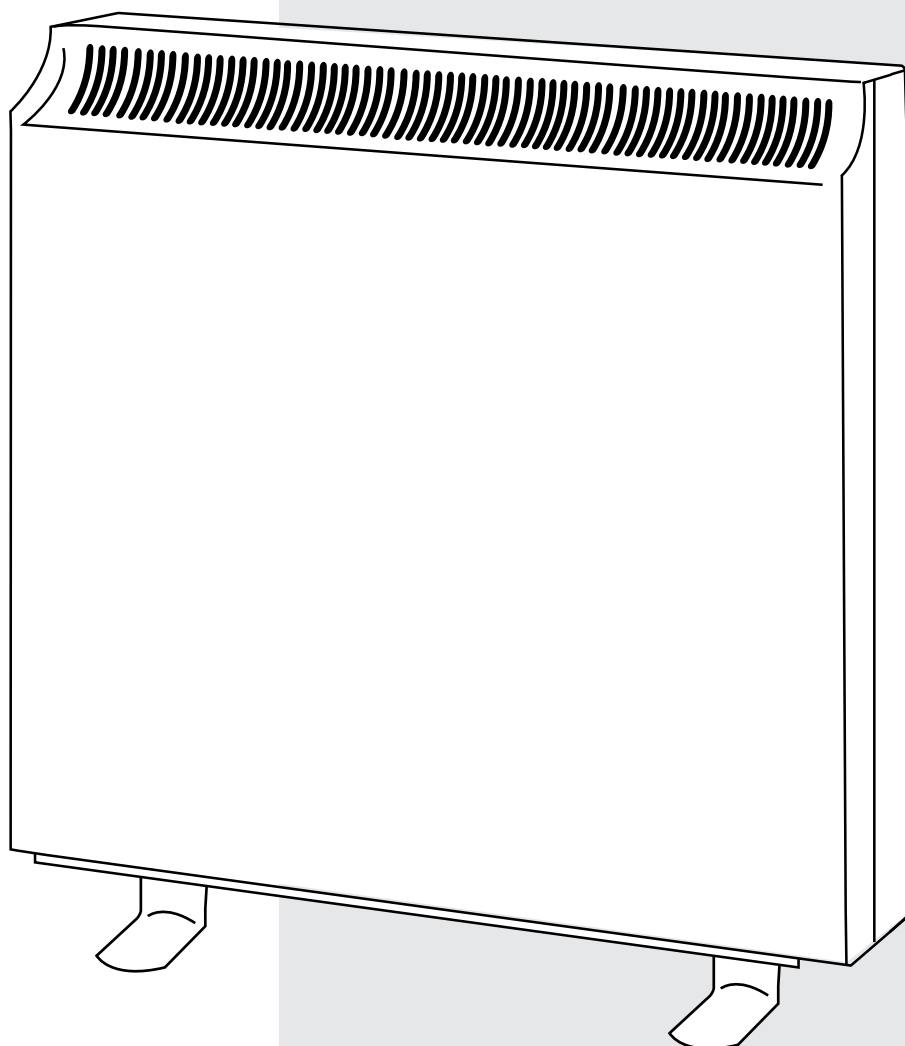

These instructions should be read carefully and retained for future reference. Note also the information given on the appliance.

## **IMPORTANT**

### **SETTING UP YOUR NEW HEATER**

Setting up your new heater, called 'commissioning' is simple as instructed on page 3. Please note that the new materials in the heater will produce a slight smell for the first few days of operation. **Rooms must be well ventilated and young children, caged birds, or persons with respiratory complaints must not remain in close proximity to the heater during the first 48 hours of the set-up period.** If several new heaters have been installed it's recommended that the set-up for each one (commissioning) is phased over several days.

#### **WARNING - THE SURFACE OF THIS HEATER CAN BE HOT.**

- The surface temperatures of this heater are within the requirements of EN60335-2-61, the European Standard covering the safety requirements for Electric Storage Heaters, and momentary contact with any part of the heater should not cause injury. However, in order to be effective, heaters of any type do get hot, especially around the air outlet grille.
- If aged or infirm persons, or young children, are likely to be left unsupervised in the vicinity of a heater precautions should be taken to ensure that prolonged contact with the heater cannot occur. We recommend that a guard is fitted around the heater, as is normal with some types of heating appliances in similar circumstances. A range of guards specially designed for Dimplex storage heaters is available. If you require further information on these guards, please see contact details on back page.
- This appliance is not intended for use by persons (including children) with reduced physical, sensory or mental capabilities, or lack of experience and knowledge, unless they have been given supervision or instruction concerning use of the appliance by a person responsible for their safety.
- Children should be supervised to ensure that they do not play with the appliance.

#### **CAUTION: DO NOT COVER SURFACES OF THE HEATER AND DO NOT OBSTRUCT AIR OUTLET GRILLES.**

- Surfaces of the heater should not be covered or obstructed as this can cause excessive temperatures that can be hazardous and may cause safety cut-outs to operate.
- Do not put clothes, fabrics or any combustible materials on the heater.
- Do not allow curtains to come within 75mm (3") of the top and ends of the heater.
- **DO NOT SIT OR STAND ON THE HEATER.**
- **DO NOT PLACE OBJECTS IN CONTACT WITH THE HEATER.**

#### **PLEASE NOTE: YOUR STORAGE HEATER IS VERY HEAVY AND MUST BE SECURELY FIXED TO A SOUND WALL.**

- No attempt should be made to move the heater without first seeking specialist advice. If you are not happy that the heater has been securely fixed, please inform your installer.
- If, during any reassembly of the heater, a part of the thermal insulation shows damaged or deterioration which may impair safety, it should be replaced with an identical part.
- **UNDER NO CIRCUMSTANCES SHOULD THE WALL FIXINGS BE LOOSENED ON THIS HEATER BEFORE THE BRICKS HAVE BEEN REMOVED FROM ITS CORE.**

## The benefits of storage heating

One of the benefits of storage heaters is that after their night-time intake of off-peak electricity i.e. the 'charge' they will always emit some heat throughout the day and night. This helps to maintain a steady temperature so that the room never gets cold, because the whole fabric of the room retains some warmth.

In the morning, when the core is at its hottest, the amount of heat being transmitted is at its greatest and the heater feels hot over most of its upper surfaces.

As the day progresses, heat is transmitted from the heater to the room and the surface of the heater becomes less hot.

If the amount of emitted heat becomes insufficient the output of the heater and thus the room temperature may be increased by using the Output Control.

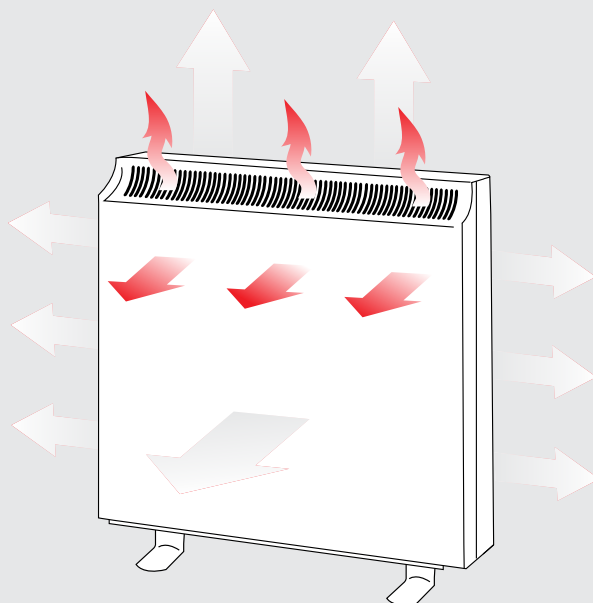

## Know your heater

Off-peak electricity is supplied from the national grid to your house, usually overnight, when national demand for electricity is low. This is called the off-peak period.

Because it is off-peak it is supplied at a cheaper price than normal day rate electricity and requires a separate off-peak electrical circuit and meter. This circuit only operates the storage heaters, and switches on automatically during the off-peak time period which will occur at set times of the night or day. If you are unsure which off-peak tariff you have, you will need to contact your electricity supplier for clarification.

In the same way as you charge up a battery, electricity is used to heat elements in your heater, which over a number of hours, gradually transfer the heat to a very high density material that absorbs and stores the heat for use during the next day. This process is referred to as 'charging' the heater.

In order to ensure your room stays warm overnight, storage heaters are designed to give out some heat even when the heater is 'charging'.

When the off-peak 'charging' period finishes the heat is gradually released in a controlled way over the course of the day.

Storage heating can be used to provide all of your room heating or as background heating which can be easily topped up with supplementary heating as required.

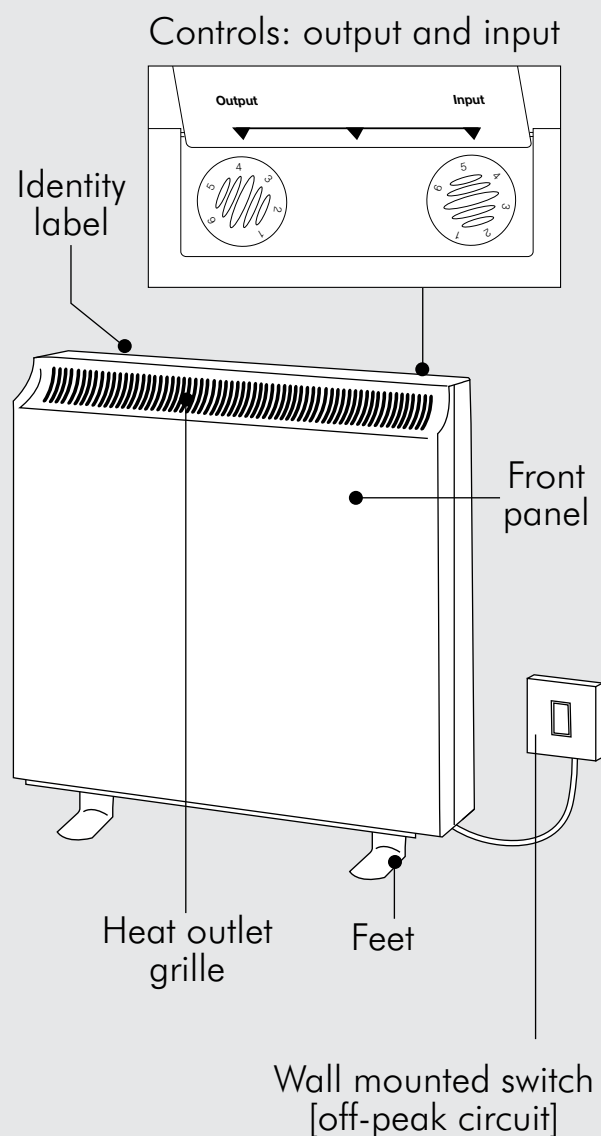

# Setting up your new heater

## ① The controls

There are two simple controls located at the top right of the heater, under the hinged flap. To adjust the controls, use a coin and engage it in the slots provided. User adjustable controls are not provided on model XMX706N.

② **To commission a new heater** set both the INPUT and OUTPUT controls to 6 and leave for 48 hours, after this period the controls should be adjusted for everyday use. Please remember that any changes you make will take at least 24 hours to take effect.

**IMPORTANT** - The new materials in the heater are likely to produce a smell for the first few days of operation.

**Rooms must be well ventilated and young children, caged birds, or persons with respiratory complaints must not remain in close proximity to the heater during the first 48 hours of the set-up period.**

## Multiple installations

If several new heaters have been installed it's recommended that the set up (commissioning) is phased over several days.

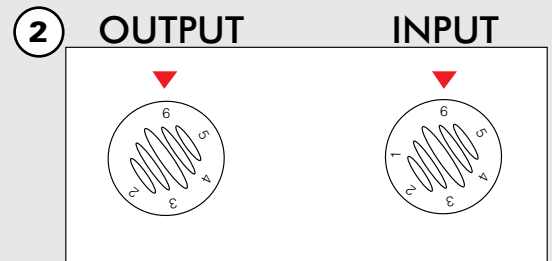
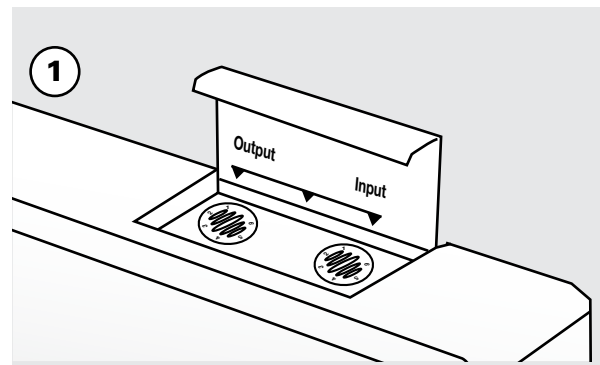

# Setting up your heater for normal use

## 'INPUT' energy control

The INPUT controls the amount of off-peak electricity – i.e. the 'charge', going into the heater at night, and therefore it controls how much heat is stored within the heater ready for use the next day.

The more electricity that goes in, the more heat is stored and available for use the following day.

## 'Auto' Models XMS712N, XMS718N, XMS724N only.

The setting of the INPUT controls on these models automatically determines the temperature of the room at the end of the off-peak charge period.

This is measured by a temperature sensor on the heater which senses both the temperature inside the heater and the room temperature. Once a comfortable INPUT setting has been found, the XMS will compensate for changes in weather conditions automatically.

## Setting the INPUT control

③ The INPUT control should initially be set at 4.

④ During the day after the first charge period the comfort level provided by the heater should be noted. If it is felt that the level of heating is either too high or too low, then the INPUT control should be adjusted up or down by half divisions as appropriate before the next charge period. This process should be repeated each day until the most acceptable comfort conditions are arrived at.

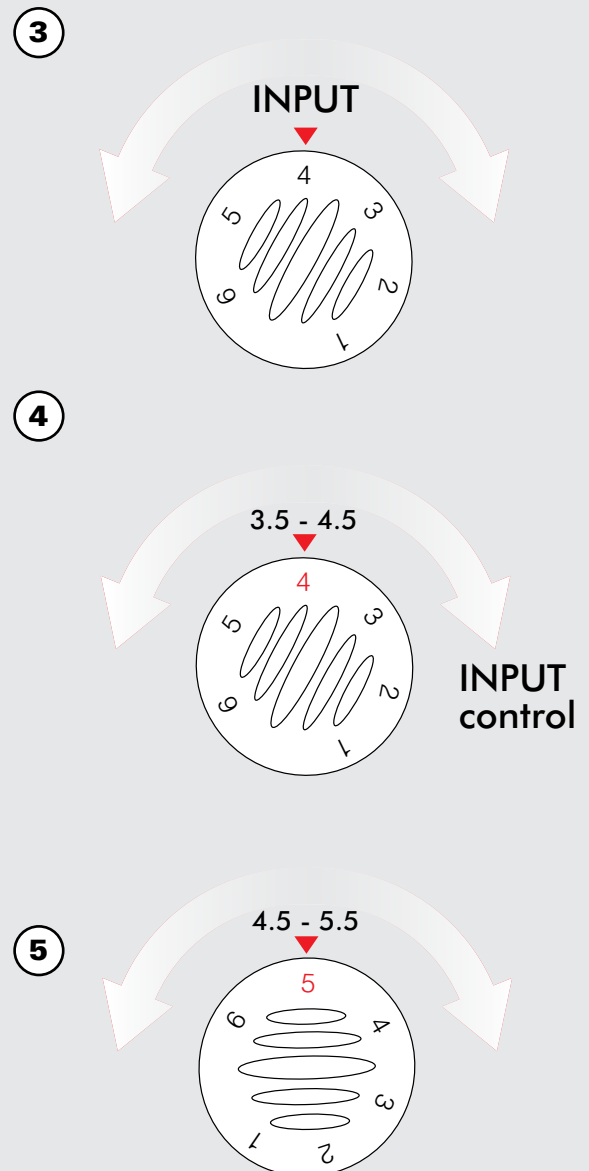

**TIP** The INPUT control can be left at the established comfort setting and the heater will automatically vary the charge taken to maintain the setting. BUT the actual setting will be influenced by the prevailing weather conditions, the room size and insulation levels of your home. The most suitable settings will be found by experience.

## Manual Models XMX712N, XMX718N, XMX724N only

The setting of the INPUT control on these models is manual, it will need to be manually adjusted and set depending on weather conditions.

⑤ Initially set the INPUT to '5'. If the level of heating is too high or too low, adjust the INPUT control up or down from 4.5 to 5.5 as appropriate before the next charge period.

**TIP** The INPUT control should be set to max '6' for Winter but if the heater is too warm adjust down by half a division at a time. Remember any changes will take 24 hours to take effect.

Please note: Model XMX706N has no user controls

## 'OUTPUT' boost heating control

Models XMS712N, XMS718N, XMS724N, XMX712N, XMX718N, XMX724N only.

⑥ This controls the airflow release through the heater and can be used to release heat faster or as a boost of heat later in the day.

Depending upon the amount of charge accepted by the heater, the OUTPUT control allows the release of additional heat, 'the boost', by increasing the air flow through the heater. By altering the setting of the OUTPUT control, the airflow release can be opened and closed manually, or can be set to open automatically.

Because the manual or automatic opening of the airflow release is primarily dependent on how much heat remains in the heater, the amount of charge the heater has taken has a bearing on the time at which it opens. The boost will not operate and the internal flap will not open if the output of the heater is already high enough, or if there is insufficient heat available from the product.

### Manual 'BOOST' operation

⑦ With the OUTPUT control on minimum '1' the airflow release [boost] remains closed, and heat is released from the heater only by normal radiation and convection. This alone may provide sufficient heat on many occasions and therefore no adjustment of the OUTPUT control is necessary.

⑧ If a boost of heat is required later in the day, then moving the OUTPUT control to maximum '6' in the evening will immediately open the airflow to release more heat.

**TIP** When the next charging period starts the airflow release will automatically close. If you want to retain the optimum amount of heat for a boost the next day, ensure you reset the output to position '1' before the start of the next charging period which is normally overnight.

### Automatic 'BOOST' operation

Turning the OUTPUT control **to settings beyond (1) minimum**, results in an automatic boost of heat.

⑨ A high setting on the OUTPUT control at '6' opens the airflow release early afternoon/evening.

⑩ A lower setting opens the airflow later in the evening. At '3' the boost will start in the evening.

**The most suitable settings of the OUTPUT control for different conditions will be found by experience.**

**TIP** Remember - a high setting of the OUTPUT control early in the day may leave too little heat stored in the heater for the evening, especially during cold weather conditions. If a boost is not required, e.g. when a room is unoccupied for a long period, set the OUTPUT control to '1'.

### Commercial use

⑪ For commercial use i.e. normal office hours, set the OUTPUT to maximum '6' [clockwise]. Set the INPUT for your particular model as described on page 3.

### Model XMX706N

There are no user controls on this model.

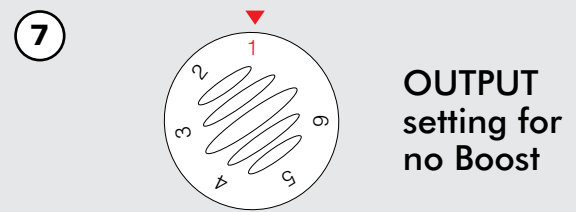
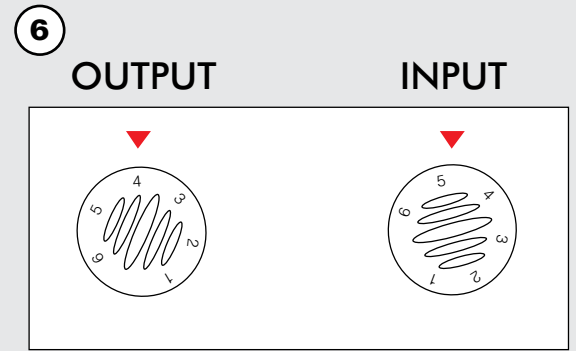

**OUTPUT setting for no Boost**

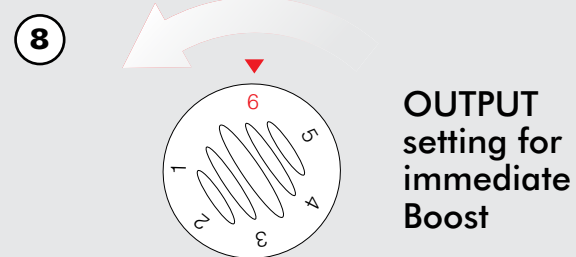

**OUTPUT setting for immediate Boost**

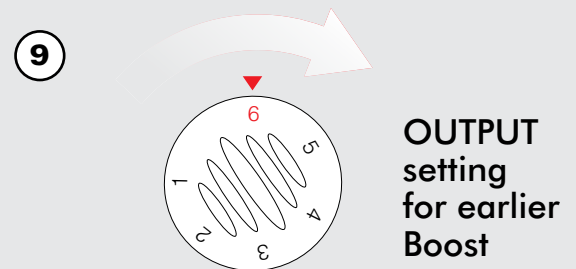

**OUTPUT setting for earlier Boost**

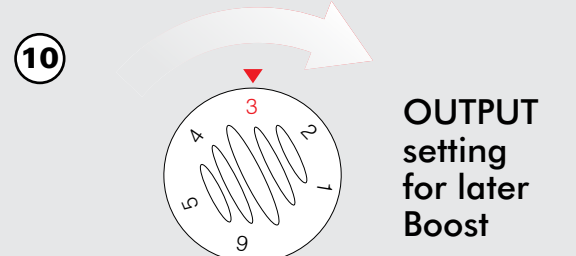

**OUTPUT setting for later Boost**

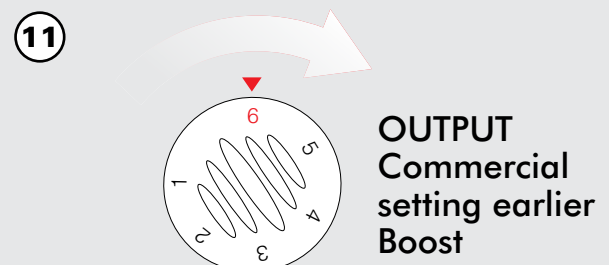

**OUTPUT Commercial setting earlier Boost**

# Seasonal settings

## Summer

① In summer when you hopefully don't need any heat you can switch the heater off at the wall socket. Turn it on again when you need heating.

**TIP** Remember there will be a delayed reaction from the heater until the beginning of the charge period when you switch on again.

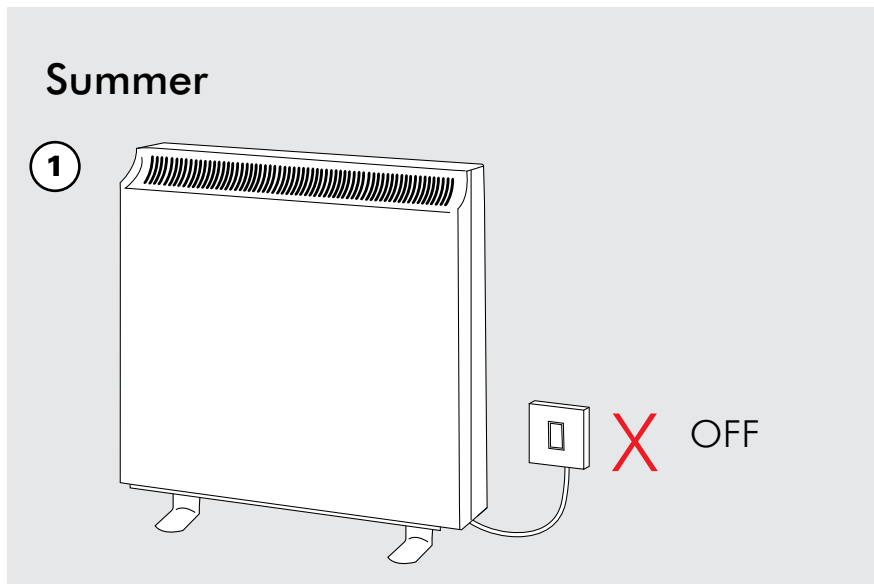

## Preparing for colder weather

② Remember to turn the heater on at the wall switch.

- Allow 24-48 hours for the heater to 'charge'.
- Adjust the controls as necessary.
- The INPUT control for XMS models should not need to be seasonally adjusted.

**TIP** The INPUT control for XMX (manual models) should be set to max '6' for Winter but a lower setting '4' should be sufficient during Spring and Autumn. But if the heater is not providing the correct level of heat it should be adjusted up or down as appropriate by a half division at a time. Remember, any changes will take 24 hours to take effect

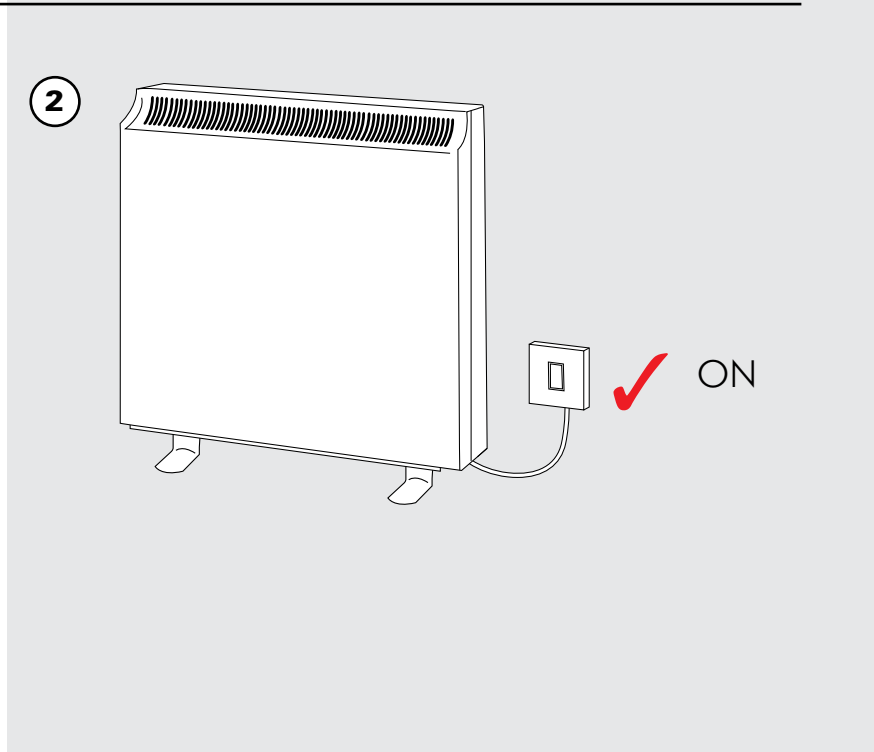

## Holidays

③ In the summer the heater can be turned off at the wall switch.

④ In the winter set at a low setting '2-3' to protect the room from frost.

**TIP** Remember when you switch the heater on again it may need a 'charge' before heat is available. There may be a delay of 24-48 hours before heat is available.

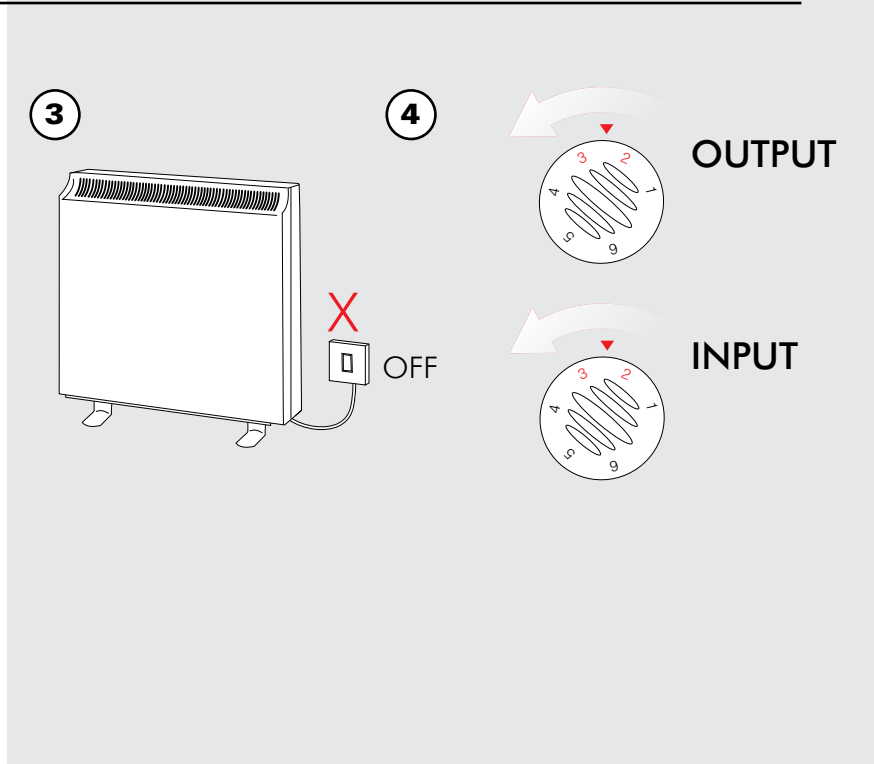

## Troubleshooting guide

Please note this guide refers to heaters being operated individually. If a central control system is installed some issues may require that you refer to the instructions provided with the system controlling the heaters.

ISSUE	SOLUTION
My heater is too cold	<ul style="list-style-type: none"> <li>• Has there been an interruption to mains power? A power cut during the off-peak period could affect the charge taken by the heater.</li> <li>• Ensure that the off-peak circuit is working, the wall switch is on, fuse is ok and consumer unit or fuse box is switched on.</li> <li>• Turn up the INPUT control (this may take up to 24hrs to take effect).</li> <li>• Has the heater been inadvertently covered? If so, the safety cut-out may have operated. Please call Customer Services if this is the case.</li> <li>• Do you have another heater nearby? If so please see 'One of my heaters is colder than the other' below.</li> <li>• Is the room cold? If you have an automatic (XMS) heater the room temperature will have an effect on the charge taken, therefore if the room is already warm the heater will not take an unnecessary charge.</li> </ul>
My heater is too hot	<ul style="list-style-type: none"> <li>• Turn the INPUT control down (this may take up to 24hrs to take effect). Turn the OUTPUT control to minimum.</li> </ul>
One of my heaters is colder than another	<ul style="list-style-type: none"> <li>• If two automatic (XMS) heaters are fitted in one area, they may affect each others' operation.</li> <li>• Set one heater higher as a 'primary' source of heat, and the other lower to provide 'supporting' heat to avoid the heaters cancelling each other out and taking a reduced charge.</li> </ul>
My room is not warm enough in the evening	<ul style="list-style-type: none"> <li>• Turn the INPUT control up. Turn the OUTPUT control down. (This may take up to 24hrs to take effect).</li> <li>• Alternatively, set the OUTPUT control to minimum, turning it to maximum in the evening when you want more heat. Return it to minimum before you go to bed so that the heater can take a full charge.</li> <li>• If adjacent rooms are not heated, this will affect the temperature of the room you are heating.</li> </ul>
My heater smells, other than that caused during commissioning	<ul style="list-style-type: none"> <li>• Apart from the commissioning period and an accumulation of dust within the heater (e.g. after long periods of inactivity) no smells should be present. One exception is when decoration is being carried out, especially if the substances used have a petrochemical base.</li> <li>• If decorating is to be carried out, turn off the storage heater and ensure the room is well ventilated before the heater is turned back on again.</li> </ul>
The storage heater has left black marks on the wall	<ul style="list-style-type: none"> <li>• Lit cigarettes, candles and oil burners, combined with the convection effect of a storage heater can cause soot deposits to build up on the surface directly above and to the sides of the heater.</li> <li>• Installing a shelf above the heater is one solution, as the heat rising above the heater will be diverted away from the wall and into the centre of the room. Please ensure a minimum of 250mm clearance between the top of the heater and the shelf.</li> </ul>

## Cleaning

To maintain the external appearance of the radiator it need only be wiped over occasionally with a dry duster. During the summer months, or at other times when the appliance is not in use and is completely cold, the opportunity should be taken to wipe over with a damp cloth. Do not use abrasive cleaning powders or furniture polish.

Discoloration of wall finishes can sometimes occur immediately above a storage heater due to the properties of some paints and decorating materials or the presence of environmental impurities in the air (such as soot or incense generated from the burning of candles, etc.) A suitable shelf (available from Dimplex) may be fitted to limit the extent of any wall discoloration.

## After sales service

Your product is guaranteed for two years from the date of purchase.

Within this period, we undertake to repair this product free of charge provided it has been installed and operated in accordance with these instructions.

Your rights under this guarantee are additional to your statutory rights, which in turn are not affected by this guarantee.

**Should you require after sales information please go to [www.dimplex.co.uk](http://www.dimplex.co.uk) where you will find our self help guides and videos by clicking on 'Customer Support'. If you cannot find the information you need, a simple online form is provided for your convenience, or contact the number below.**

You will need the model number, serial number and series, date of purchase, and nature of the fault to complete the online form or before contacting us.

Please do not return a faulty product to us in the first instance as this may result in loss or damage and delay in providing you with a satisfactory service.

Please retain your receipt as proof of purchase.

## Spare parts

Spare parts information is available on the website [www.dimplex.co.uk](http://www.dimplex.co.uk), and the customer services help desk will be able to advise you should you need to purchase any spares.

You will need the model number, serial number and series, date of purchase, and nature of the fault to complete the online form or before contacting us.

## Protective guards

A range of protective guards designed for Dimplex storage heaters is available to order. For more information contact Norfolk Industries on 01603 667957.

## Recycling

For electrical products sold within the European Community.

At the end of the electrical products useful life it should not be disposed of with household waste. Please recycle where facilities exist. Check with your Local Authority or retailer for recycling advice in your country.



This product complies with the European Safety Standards EN60335-2-30 and the European Standard Electromagnetic Compatibility (EMC) EN55014, EN60555-2 and EN60555-3.

These cover the essential requirements of EEC Directives 2006/95/EC and 2004/108/EC

© GDC

**Dimplex**<sup>®</sup>

A world of expertise