

NEW

infra-red heaters

the IRX range

The IRX range of infra-red wall heaters are a safe, practical source of heat in bathrooms, kitchens, work areas – anywhere where fast localised heating is required.

Energy saving feature

- Choice of heat settings on IRX200N.

Other features

- Designed to provide rapid beamed warmth.
- All models have adjustable beam angle to direct heat where it's needed.
- All models are IP24 rated meaning they are suitable for permanent installation internally or externally.
- Pull cord operation.
- Silver grey finish.
- 1 year guarantee.

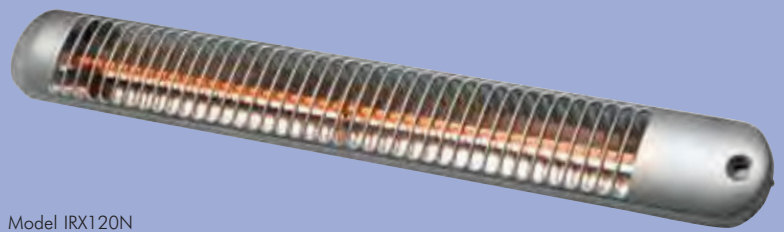

Model IRX120N

Technical specifications

Electrical Connections – All models

Supply cable is not provided. Provision is made for connection to fixed wiring only with surface wiring or flexible cord entering through a bushed hole in the bottom or side of the base plate.

IP Rating

All models are IP24 rated.

Controls

Built-in double-pole pull-cord switch

Elements

Spiral element(s) encased in transparent insulating silica sleeves.

Clearances

- 600mm to curtain
- 300mm to wall

Reflector

Angle adjustable on installation and lockable.

Fixing dimensions and positioning

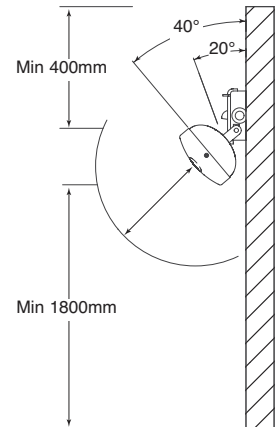

Model	Loading	Length	Height	Depth	Weight
IRX50N	0.5kW	764mm	114mm	92.5mm	2.0kg
IRX120N	1.2kW	764mm	114mm	92.5mm	2.0kg
IRX200N	2kW	764mm	114mm	92.5mm	2.1kg

NEW

frost watcher

the FW600

The FW600 wall mounted frost watcher is a low energy, simple to use heating appliance. Suitable for application in areas where a heating solution may not already be in place, yet a low level of heat is required to maintain a comfortable environment, such as garages/workshops, conservatories or sheds.

Energy saving feature

- Thermostatic control with frost protection setting.

Other features

- Mains on neon indicator.
- All models are IP20 rated.
- Over heat protection.
- Wall mountable only.
- Light grey/white aluminium finish.
- 1 year guarantee.

Technical specifications

Electrical

All installation must be in accordance with current IEE regulations.

Safety Protection

Manually resettable thermal overload cut-out.

Construction

Double insulated plastic case moulded in flame retardant, self extinguishing grade nylon.

Installation

Two keyhole slots are provided together with a third fixing hole to secure the heater to the wall. The heaters are supplied without a plug.



Model FW600

Model	Loading	Height	Width	Depth	Weight
FW600	600W	240mm	259mm	121mm	1.12kg